

# COMMON MODE CHOKE COIL STR804 SERIES

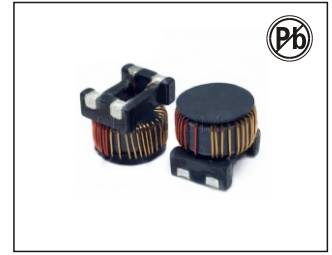

## FEATURES:

- Wire wound constructure common mode choke with best EMI suppression effect high impedance but very high rated current and low DCR.

## APPLICATIONS :

- Preventive measure against common mode noise radiation emissions from power line or else.
- Best for high current circuit such as car, wireless charging and power device design.

## ELECTRICAL CHARACTERISTICS@25°C

| Part Number | Impedance (Ω)Ref N1=N2 | Test frequency | DCR (mΩ)Max | IDC (A)Max |
|-------------|------------------------|----------------|-------------|------------|
| STR804-102  | 1000                   | 100KHz/0.25V   | 100         | 2.5        |
| STR804-132  | 1300                   | 100KHz/0.25V   | 115         | 2.4        |
| STR804-162  | 1600                   | 100KHz/0.25V   | 130         | 2.3        |

## PHYSICAL CHARACTERISTICS & WINDING

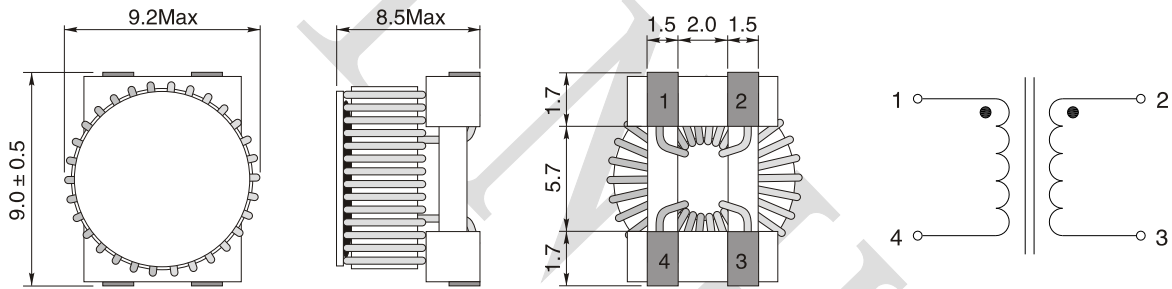

STR804-102

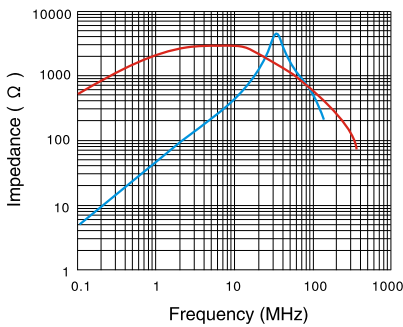

STR804-132

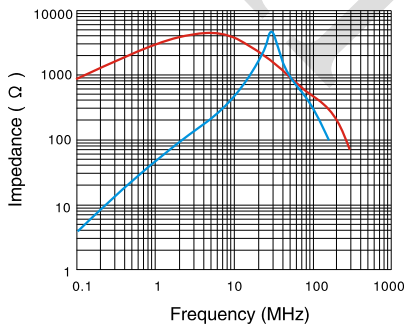

STR804-162

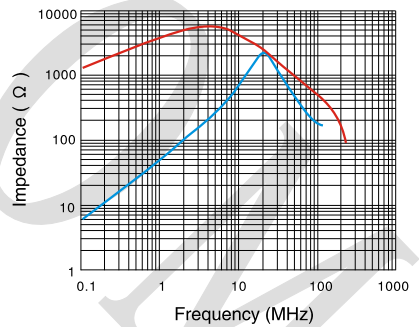

— Common mode  
— Differential mode

### Note:

- Z test with HP4191A or HP4395A
- RDC:QuadTech 1880 Milliohmeter
- Operating temperature: -40°C to +105°C
- Storage Temperature: -40°C to +105°C
- Resistance to soldering heat:260°C for 10 seconds

Note:All specifications subject to change without notice.