

# SMD HIGH CURRENT FLAT WIRE COMMON MODE CHOKE

## SQS1212 SERIES



### FEATURES:

- Compact size, low DCR, low leakage due to square core.
- High permeability material, High impedance at low frequency.
- High attenuation to noise, due to low stray capacitance.
- Flammability tested to UL 94 V-0.
- Low cost, high consistency with automated production.
- RoHS, REACH compliance, Halogen free available.

### APPLICATIONS:

- Solutions for use in a wide array of power supply circuits.
- High density switching mode power supply devices.
- Ideal for use in consumer electronics and industrial applications: LCD TV, Battery chargers, Power Adapter, Home appliances.
- Space saving for existing Common Mode Chokes.

### ELECTRICAL CHARACTERISTICS:

Part Number	Inductance (mH)Min	Common mode peak impedance (kΩ)	Leakage inductance (uH)Max	DCR (mΩ) Max	Rated current (A)Max
SQS1212-801Y	0.8	9.06@3.73MHz	80	25	3.6
SQS1212-102Y	1.0	14.12@2.9MHz	100	36	3.0
SQS1212-152Y	1.5	22.67@2.15MHz	115	52	2.5
SQS1212-252Y	2.5	31.51@2.48MHz	130	95	1.8
SQS1212-302Y	3.0	44.31@2.31MHz	130	115	1.5
SQS1212-362Y	3.6	47.1@1.96MHz	140	158	1.2
SQS1212-502Y	5.0	66.55@1.84MHz	150	216	1.0
SQS1212-682Y	6.8	81.25@1.32MHz	180	315	0.8
SQS1212-952Y	9.5	123.34@0.95MHz	210	500	0.6

### TECHNICAL INFORMATION & PHYSICAL CHARACTERISTICS:

#### DIMENSIONS IN:mm

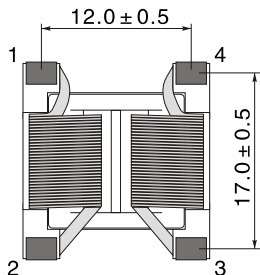
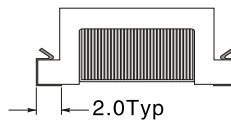
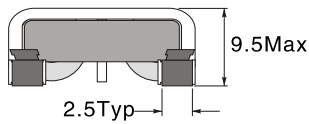
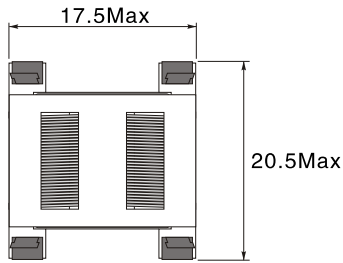

#### LAND PATTERNS

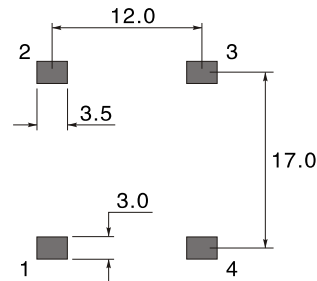

- Inductor Testing: HP4284A (Equivalent acceptable)
- DCR: QuadTech 1880 Milliohm meter
- Rated voltage: 80VAC- 280VAC
- High withstanding voltage between windings: 2400VAC /60 sec.
- High Insulation resistance 100MΩ Min @ 500VDC between windings.
- Operating temperature: -40°C ~ +125°C (Including coil temperature rise).
- Storage temperature: -40°C ~ +85°C.
- Solder methods: Vapor Phase, Infrared Reflow
- Resistance to soldering heat: 260°C for 10 seconds
- Solvent resistance: Conforms to MIL-STD-202E

# IMPEDANCE VS FREQUENCY:

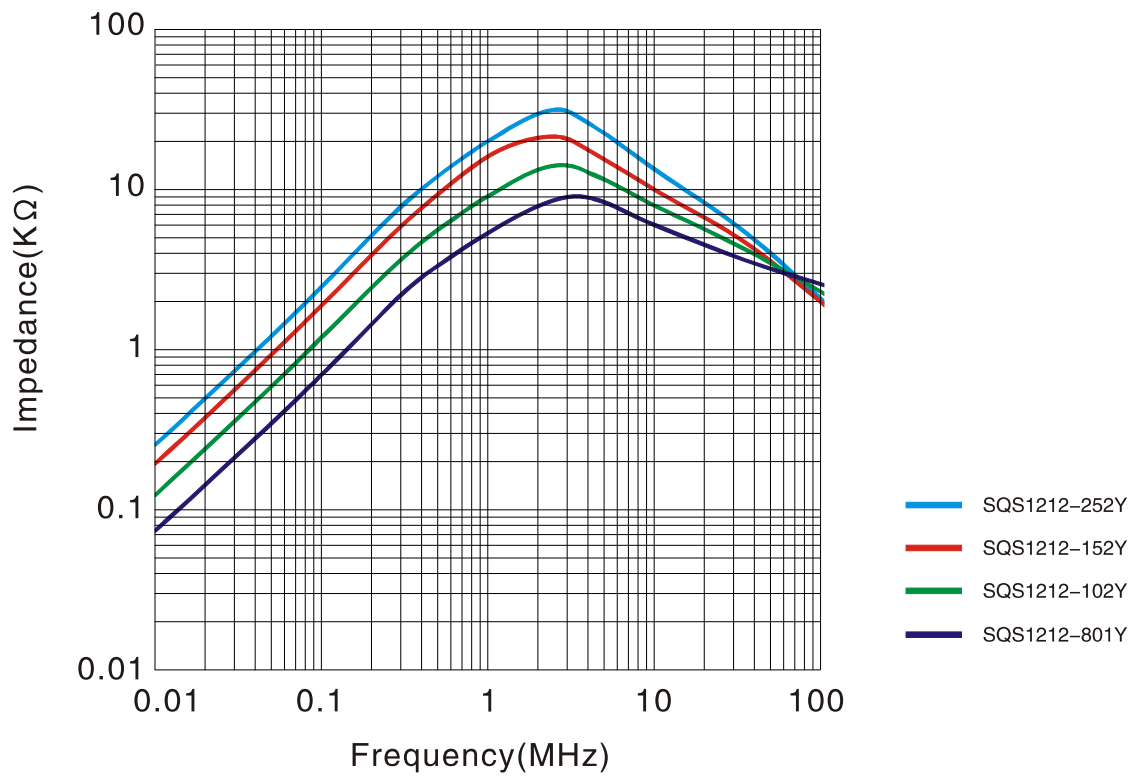
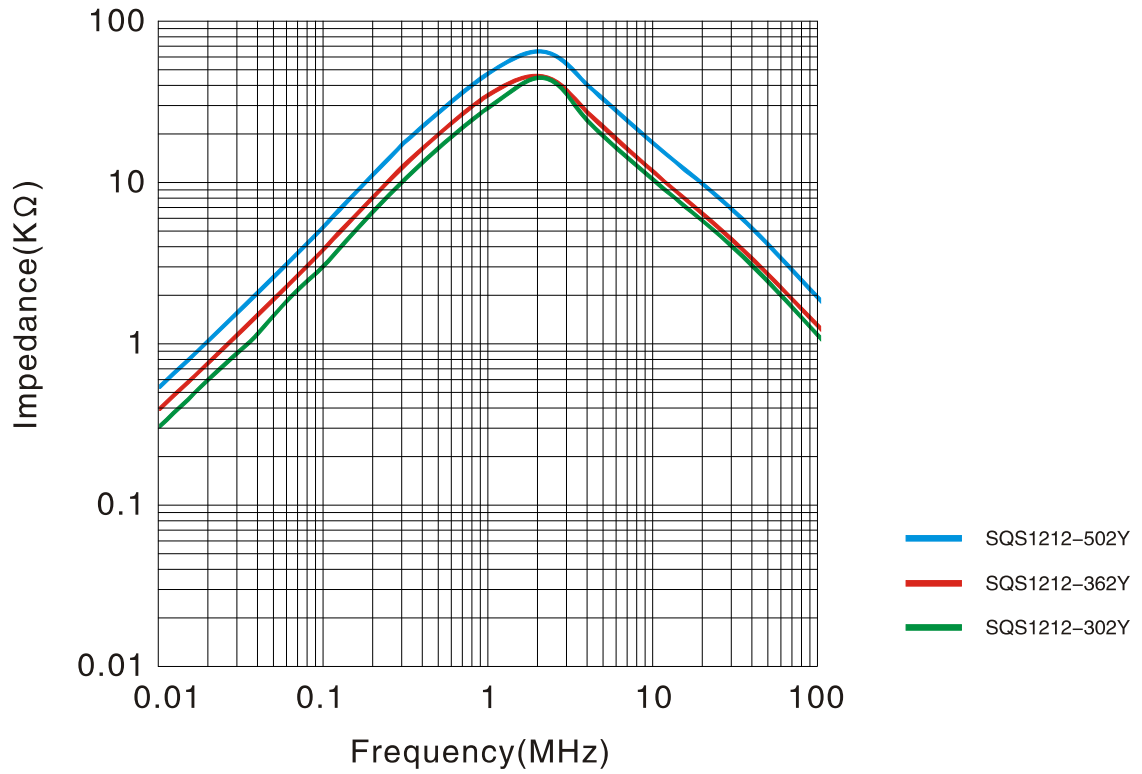

# SMD HIGH CURRENT FLAT WIRE COMMON MODE CHOKE

## SQS1212HP SERIES

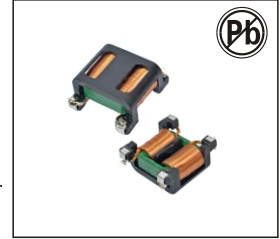

### FEATURES:

- Compact size, low DCR, low leakage due to square core.
- High permeability material, High impedance at low frequency.
- High attenuation to noise, due to low stray capacitance.
- Flammability tested to UL 94 V-0.
- Low cost, high consistency with automated production.
- RoHS, REACH compliance, Halogen free available.

### APPLICATIONS:

- Solutions for use in a wide array of power supply circuits.
- High density switching mode power supply devices.
- Ideal for use in consumer electronics and industrial applications: LCD TV, Battery chargers, Power Adapter, Home appliances.
- Space saving for existing Common Mode Chokes.

### ELECTRICAL CHARACTERISTICS:

Part Number	Inductance (mH)Min	Common mode peak impedance (k $\Omega$ )	Leakage inductance (uH)Max	DCR (m $\Omega$ ) Max	Rated current (A)Max
SQS1212HP-182Y	1.8	5.98@2.69MHz	120	25	3.6
SQS1212HP-252Y	2.5	7.37@2.56MHz	130	36	3.0
SQS1212HP-362Y	3.6	11.72@2.34MHz	140	52	2.5
SQS1212HP-582Y	5.8	17.69@2.23MHz	160	95	1.8
SQS1212HP-702Y	7.0	19.62@2.15MHz	200	115	1.5
SQS1212HP-852Y	8.5	26.22@2.01MHz	200	158	1.2
SQS1212HP-123Y	12.0	32.44@1.55MHz	230	216	1.0
SQS1212HP-153Y	15.0	39.25@1.15MHz	280	315	0.8
SQS1212HP-223Y	22.0	57.64@0.85MHz	360	500	0.6

### TECHNICAL INFORMATION & PHYSICAL CHARACTERISTICS:

#### DIMENSIONS IN:mm

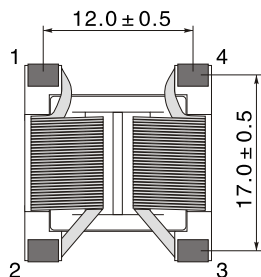
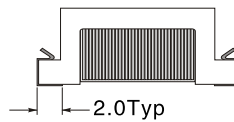
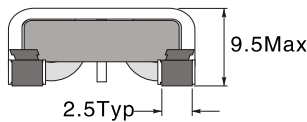
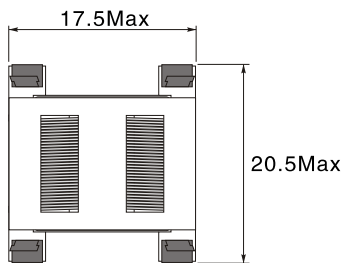

#### LAND PATTERNS

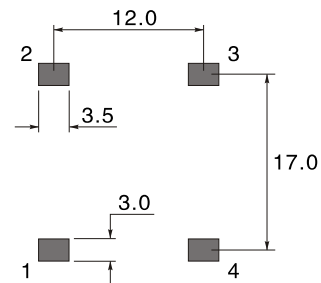

- Inductor Testing: HP4284A (Equivalent acceptable)
- DCR: QuadTech 1880 Milliohm meter
- Rated voltage: 80VAC- 280VAC
- High withstanding voltage between windings: 2400VAC /60 sec.
- High Insulation resistance 100M $\Omega$  Min @ 500VDC between windings.
- Operating temperature: -40 $^{\circ}$ C ~ +125 $^{\circ}$ C (Including coil temperature rise).
- Storage temperature: - 40 $^{\circ}$ C ~ +85 $^{\circ}$ C.
- Solder methods: Vapor Phase, Infrared Reflow
- Resistance to soldering heat: 260 $^{\circ}$ C for 10 seconds
- Solvent resistance: Conforms to MIL-STD-202E

# IMPEDANCE VS FREQUENCY:

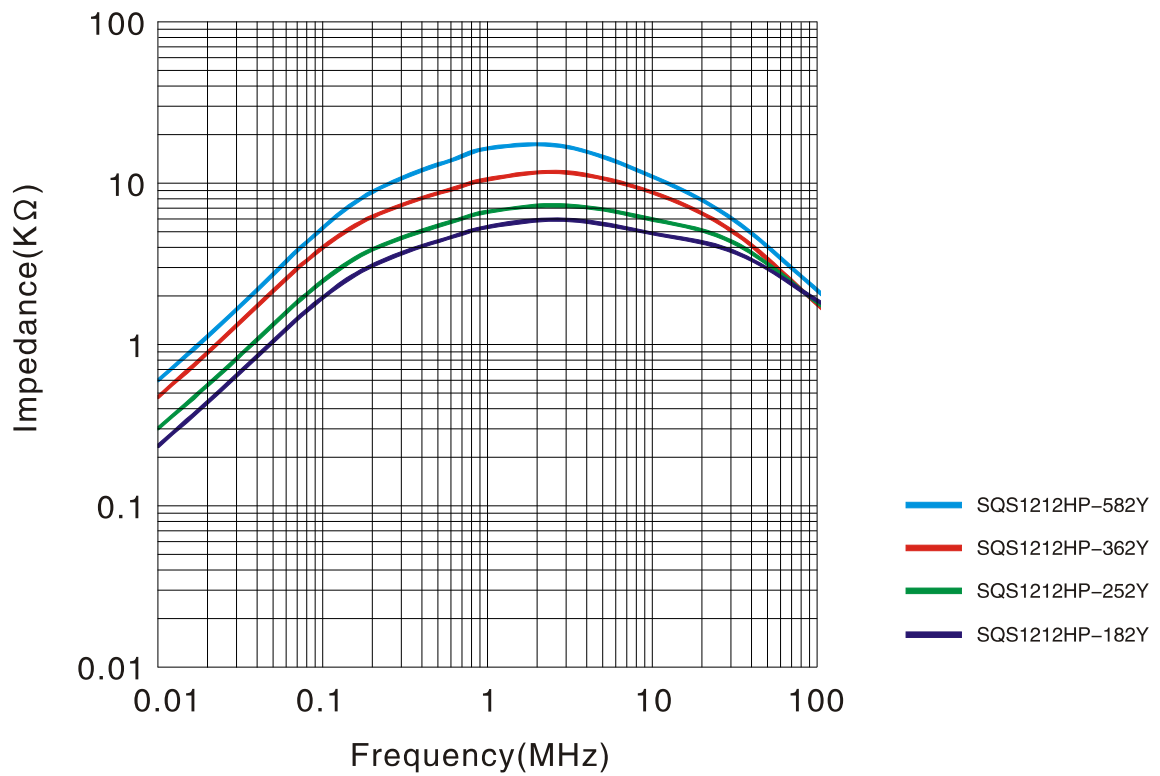
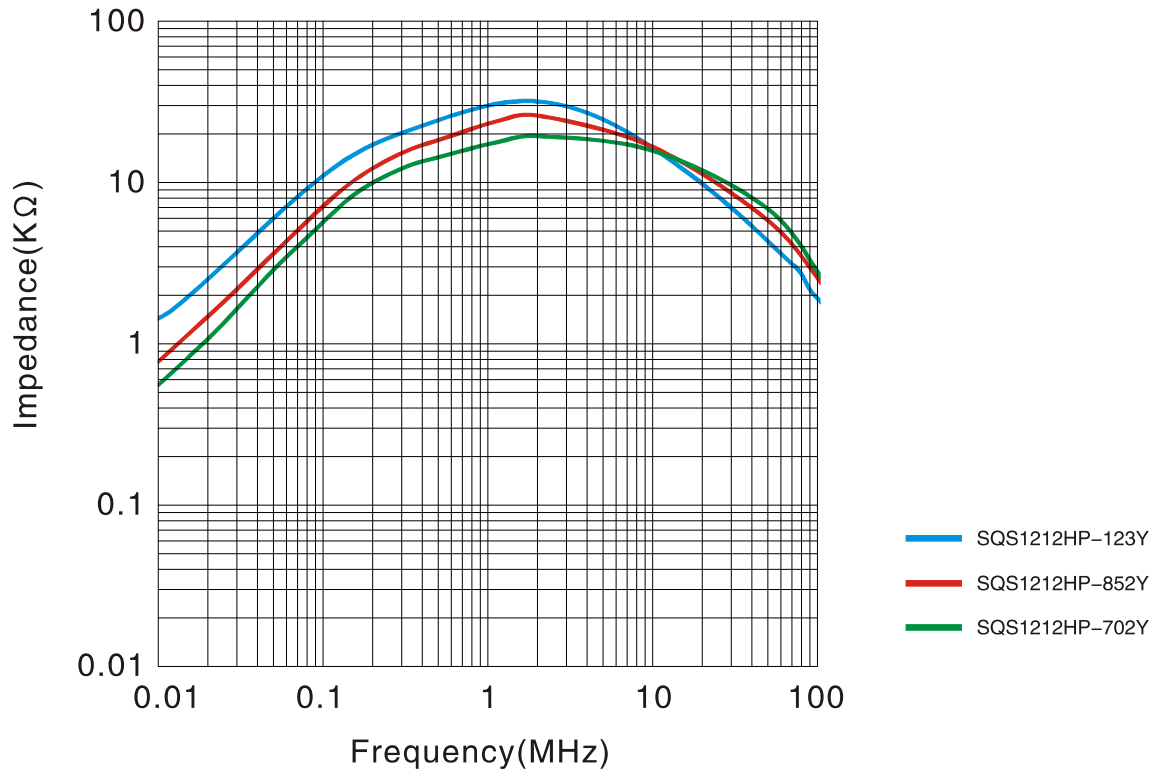

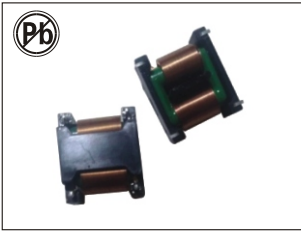

# SMD Flat Common Mode Chokes

## SQS1515A SERIES

### FEATURES:

- Compact size, low DCR, low leakage due to square core
- High permeability material, High impedance at low frequency
- High attenuation to noise, due to low stray capacitance
- Flammability tested to UL94V-0
- High withstanding voltage between winding
- High insulation resistance
- Low cost, high consistency with automated production
- RoHS, REACH compliance

### APPLICATION:

- Solutions for use in a wide array of power supply circuits
- High density switching mode power supply devices
- Ideal for use in consumer electronics and industrial applications: LCD TV, Battery chargers, Power Adapter, Home appliances
- Space saving for existing Common Mode Chokes

### ELECTRICAL CHARACTERISTICS:

Part Number	Inductance Min. (mH).	DCR Max. (mΩ).	Rated current (A)
SQS1515A-203-1.5A	20.0	250	1.5-2.0
SQS1515A-153-1.8A	15.0	200	1.8-2.2
SQS1515A-153-2.0A	15.0	180	2.0-2.8
SQS1515A-103-2.0A	10.0	150	2.0-2.5
SQS1515A-103-2.5A	10.0	80	2.5-3.0
SQS1515A-502-2.5A	5.0	80	2.5-3.5
SQS1515A-302-3.5A	3.0	70	3.5-4.5
SQS1515A-202-5.0A	2.0	60	5.0-5.0

### TECHNICAL INFORMATION & PHYSICAL CHARACTERISTICS:

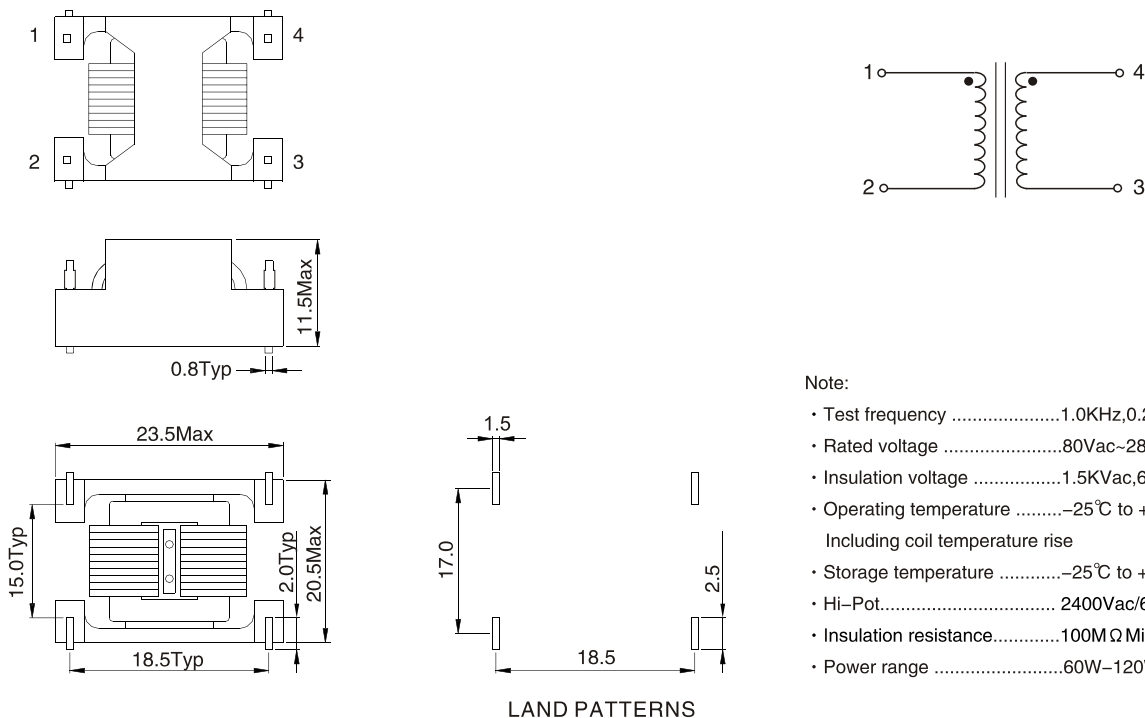

Note:

- Test frequency .....1.0KHz, 0.25V
- Rated voltage .....80Vac~280Vac
- Insulation voltage .....1.5KVac, 60Sec
- Operating temperature .....-25°C to +125°C  
Including coil temperature rise
- Storage temperature .....-25°C to +100°C
- Hi-Pot..... 2400Vac/60Sec
- Insulation resistance.....100MΩ Min@500Vdc
- Power range .....60W-120W

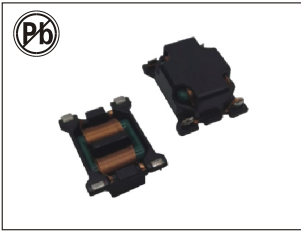

# SMD Flat Common Mode Chokes

## SQS1515B SERIES

### FEATURES:

- Compact size, low DCR, low leakage due to square core
- High permeability material, High impedance at low frequency
- High attenuation to noise, due to low stray capacitance
- Flammability tested to UL94V-0
- High withstanding voltage between winding
- High insulation resistance
- Low cost, high consistency with automated production
- RoHS, REACH compliance

### APPLICATION:

- Solutions for use in a wide array of power supply elreuits
- High desity switching mode power supply devices
- Ideal for use in consumer electroinics and industrial applications: LCD TV, Battery chargers, Power Adapter, Home appliances
- Space saving for existing Common Mode Chokes

### ELECTRICAL CHARACTERISTICS:

Part Number	Inductance Min. (mH).	DCR Max. (mΩ).	Rated current (A)
SQS1515B-203-1.5A	20.0	250	1.5-2.0
SQS1515B-153-1.8A	15.0	200	1.8-2.2
SQS1515B-153-2.0A	15.0	180	2.0-2.8
SQS1515B-103-2.0A	10.0	150	2.0-2.5
SQS1515B-103-2.5A	10.0	80	2.5-3.0
SQS1515B-502-2.5A	5.0	80	2.5-3.5
SQS1515B-302-3.5A	3.0	70	3.5-4.5
SQS1515B-202-5.0A	2.0	60	5.0-5.0

### TECHNICAL INFORMATION & PHYSICAL CHARACTERISTICS:

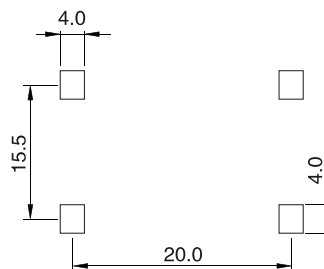
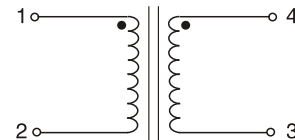
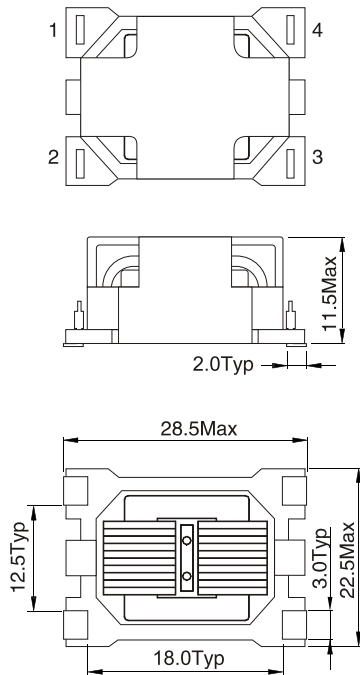

LAND PATTERNS

Note:

- Test frequency .....1.0KHz, 0.25V
- Rated voltage .....80Vac~280Vac
- Insulation voltage .....1.5KVac, 60Sec
- Operating temperature .....-25°C to +125°C  
Including coil temperature rise
- Storage temperature .....-25°C to +100°C
- Hi-Pot..... 2400Vac/60Sec
- Insulation resistance.....100MΩ Min@500Vdc
- Power range .....60W-120W

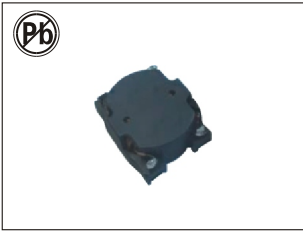

# SMD Flat Common Mode Chokes

## SQS1918 SERIES

### FEATURES:

- Compact size, low DCR, low leakage due to square core
- High permeability material, High impedance at low frequency
- High attenuation to noise, due to low stray capacitance
- Flammability tested to UL94V-0
- High withstanding voltage between winding
- High insulation resistance
- Low cost, high consistency with automated production
- RoHS, REACH compliance

### APPLICATION:

- Solutions for use in a wide array of power supply elreuits
- High desity switching mode power supply devices
- Ideal for use in consumer electroinics and industrial applications: LCD TV, Battery chargers, Power Adapter, Home appliances
- Space saving for existing Common Mode Chokes

### ELECTRICAL CHARACTERISTICS:

Part Number	Inductance Min. (mH).	DCR Max. (mΩ).	Rated current (A)
SQS1918-602-3.0A	6.0	100	3.0
SQS1918-123-2.0A	12.0	115	2.0
SQS1918-223-1.5A	22.0	159	1.5

### TECHNICAL INFORMATION & PHYSICAL CHARACTERISTICS:

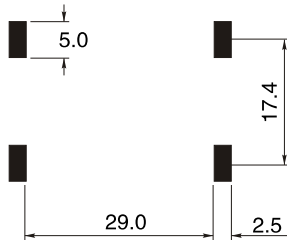
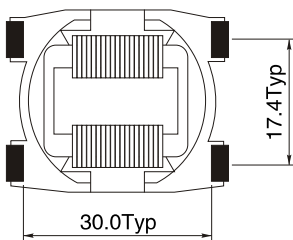
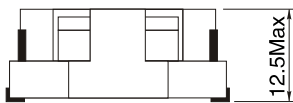
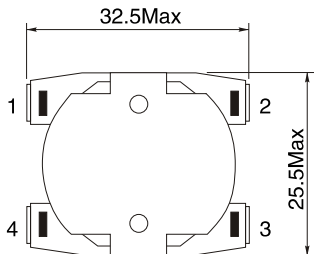

LAND PATTERNS

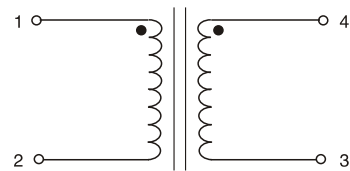

Note:

- Test frequency .....1.0KHz, 0.25V
- Rated voltage .....80Vac~280Vac
- Insulation voltage .....1.5KVac, 60Sec
- Operating temperature .....-25°C to +125°C  
Including coil temperature rise
- Storage temperature .....-25°C to +100°C
- Hi-Pot..... 2400Vac/60Sec
- Insulation resistance.....100MΩ Min @ 500Vdc