

SMD Flat Common Mode Chokes

SQS1918 SERIES

FEATURES:

- Compact size, low DCR, low leakage due to square core
- High permeability material, High impedance at low frequency
- High attenuation to noise, due to low stray capacitance
- Flammability tested to UL94V-0
- High withstanding voltage between winding
- High insulation resistance
- Low cost, high consistency with automated production
- RoHS, REACH compliance

APPLICATION:

- Solutions for use in a wide array of power supply elreuits
- High desity switching mode power supply devices
- Ideal for use in consumer electroinics and industrial applications: LCD TV, Battery chargers, Power Adapter, Home appliances
- Space saving for existing Common Mode Chokes

ELECTRICAL CHARACTERISTICS:

Part Number	Inductance Min. (mH).	DCR Max. (mΩ).	Rated current (A)
SQS1918-602-3.0A	6.0	100	3.0
SQS1918-123-2.0A	12.0	115	2.0
SQS1918-223-1.5A	22.0	159	1.5

TECHNICAL INFORMATION & PHYSICAL CHARACTERISTICS:

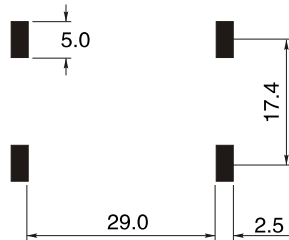
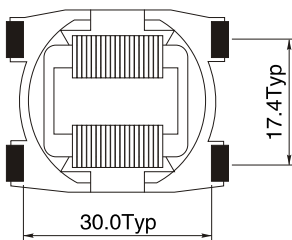
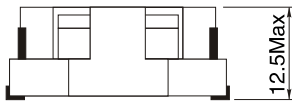
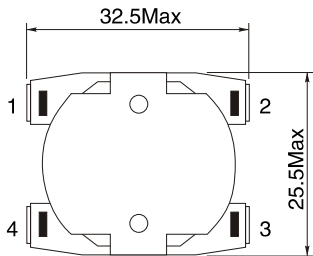

LAND PATTERNS

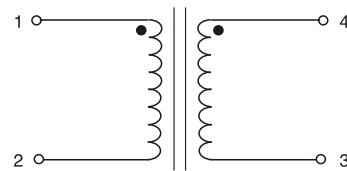

Note:

- Test frequency1.0KHz, 0.25V
- Rated voltage80Vac~280Vac
- Insulation voltage1.5KVac, 60Sec
- Operating temperature-25°C to +125°C
Including coil temperature rise
- Storage temperature-25°C to +100°C
- Hi-Pot..... 2400Vac/60Sec
- Insulation resistance.....100MΩ Min @ 500Vdc